

UL 230 - 12

12V 230AH

STANDBY

Ultrace//[®]

'Quality in Every Language'

Image

AWAITING
IMAGE

Terminal Type

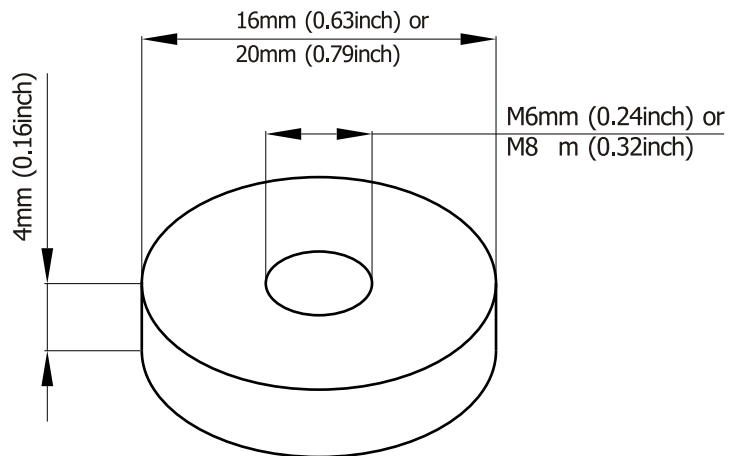

Dimensions

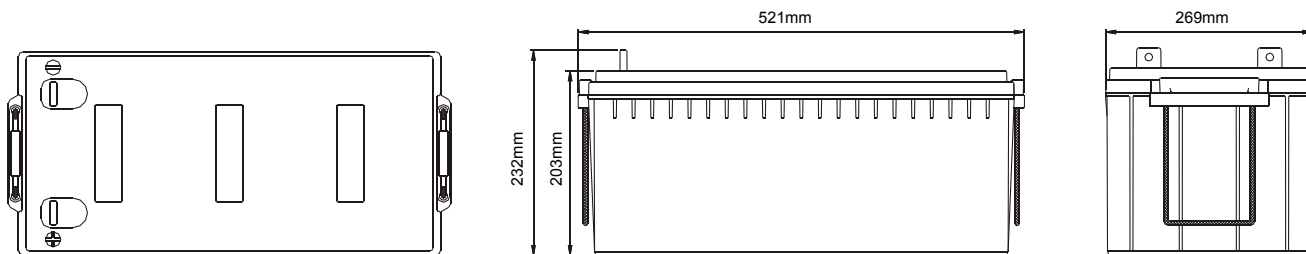

Specifications

Battery Model	UL 230 - 12			
Designed Floating Life	10 Years			
Capacity (25°C)	20HR (11.5A, 1.75V)	10HR (21.85A, 1.75V)	5HR (39.1A, 1.75V)	1HR (138A, 1.55V)
	230AH	218.5AH	195.5AH	138AH
Dimensions	Length	Width	Height	Total Height
	521mm	269mm	203mm	232 mm
Approx. Weight	70Kg			
Internal Resistance	Fully Charged at 25°C 0.15 Ohm			
Self Discharge	3% of capacity declined per month at 25°C			
Capacity Affected by Temperature	40°C	25°C	0°C	-15°C
	102%	100%	85%	65%
Charge Voltage (25°C)	Cycle Use		Float Use	
	14.0 - 15.0V (-24mV/C), max. Current: 69A		13.6 - 13.8V (-18mV/C)	

Construction

Component	Raw material	Sealant	Epoxy Resin
Positive	Lead dioxide	Safety Valve	EPDR
Negative	Lead	Terminal	Copper
Container	ABS (Flame Retardant optional)	Separator	Fibre Glass
Cover	ABS (Flame Retardant optional)	Electrolyte	Sulphuric acid

Sealed and maintenance free option *Non-spillable construction design*

UL 230 - 12

12V 230AH

STANDBY

Ultrace//[®]

'Quality in Every Language'

Charge Characteristic

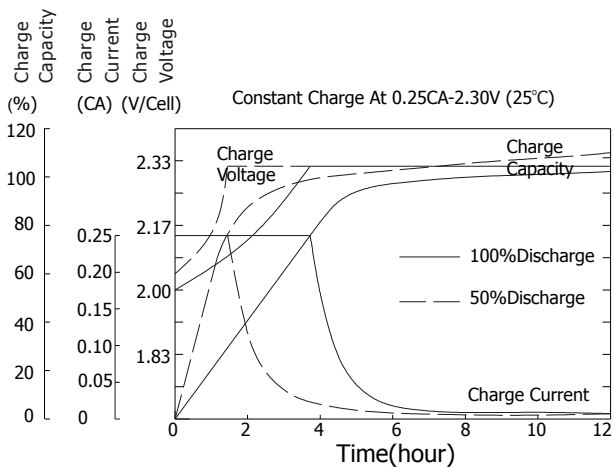

Discharge Characteristic 25°C

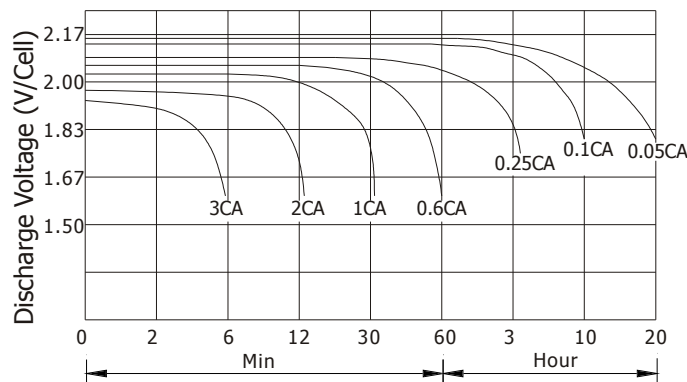

Relationship of OCV and state of charge

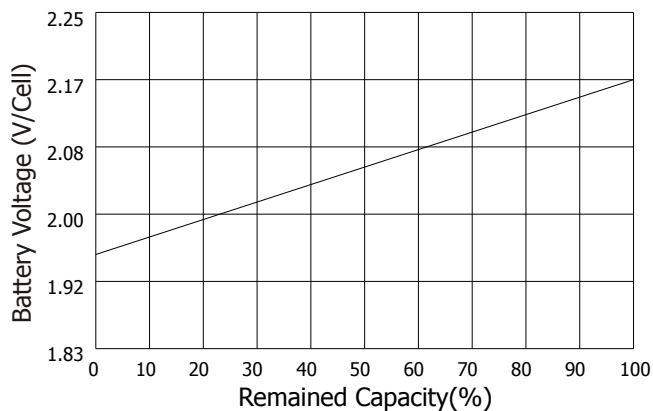

Self Discharge Characteristics

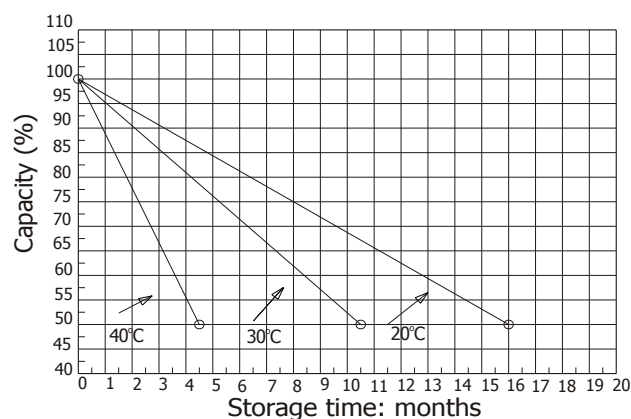

Constant Current Discharge Ratings - amperes at 25°C

F.V / Time	5 MIN	10 MIN	15 MIN	30 MIN	1 HR	3 HR	5 HR	10 HR	20 HR
1.60 V	805	552	403	242	152	62.8	43.9	24.4	12.1
1.67 V	725	504	391	235	152	62.6	43.5	24.0	12.1
1.70 V	688	485	377	230	151	62.6	43.5	23.8	12.1
1.75 V	612	449	357	225	150	62.1	43.2	23.4	12.0
1.80 V	552	416	340	219	148	61.9	42.8	23.0	11.6
1.85 V	419	343	294	201	146	61.6	42.5	22.6	10.9

Constant Power Discharge Ratings - watts at 25°C

F.V / Time	5 MIN	10 MIN	15 MIN	30 MIN	1 HR	3 HR	5 HR	10 HR	20 HR
1.60 V	1327	915	713	455	299	121	84	48.8	24.2
1.67 V	1258	904	706	446	289	121	84	48.0	24.2
1.70 V	1175	881	695	435	282	121	84	47.7	24.2
1.75 V	1095	823	653	423	279	119	83	46.9	24
1.80 V	982	766	614	412	274	117	81.7	46	23.2
1.85 V	787	635	536	377	272	117	80.5	45.2	21.8